

VIKING LINE

Conference on board



All Viking Line vessels have well equipped conference facilities for small and large groups. We offer a wide range of conference package options suitable for all needs. For further information kindly contact our Customer Service & Sales. The professional sales agents at our conference sales department will summarize your request and offer you the most suitable route and vessel. They will help you book your journey and answer all of your questions. Our professional conference center with its qualified staff on board will make sure your meeting is a success. We have the experience and the know-how to meet your needs.

Welcome on board!

Standard equipment

- Projection screen
- Flip Chart
- White board
- Pens and notebooks
- Wireless Viking Public Internet connection
- PC projector. Please note that some rooms haven't got PC projectors installed and ready in the room. Always make a note about required PC projector in the conference room booking.

Standard equipment, auditorium

- Projection screen
- Flip charts
- CD player
- DVD player
- PC projector
- Panel board
- Headset (microphone)
- Wireless hand-held microphone

Accessories for the conference rooms and/or auditorium

- Extra projection screen
- Extra flip chart
- PC loudspeakers
- Laptop available for rental, SEK 300
- Document camera

Bookings via Viking Lines Group and Conference department.

Additional conference services

- Copying (additional charges apply)

Additional information

- Speakers in some rooms
- Hearing loop in AU1 and AU2, as well as a portable one
- 6 standing desks for rental, SEK 200/table
- Conference tables 1,350 x 450. The tables can be combined in many different ways. Movable tables and chairs.

Elevator capacity to the Conference Deck 9

Elevator door width: 95 cm
Weight Capacity: 1,000kg (2,200lbs.)

Internet Connections:

Free Wi-Fi.

Viking Cinderella

Code	Furnishing	Seating capacity	Room Width, Doorway to window	Room Length, Front to back
B10	Boardroom	10	510 cm	410 cm
B21	Boardroom	17	280 cm	960 cm
B31	Classroom	15	420 cm	490 cm
	U Table	13		
B32	Classroom	13	540 cm	430 cm
	U Table	12		
B41	Boardroom	8	490 cm	320 cm
B42	Classroom	12	490 cm	450 cm
	U Table	12		
B50	Classroom	49	635 cm	1020 cm
S11	Classroom	13	580 cm	450 cm
	U Table	12		
S12	Boardroom	8	520 cm	460 cm
S21	Classroom	13	540 cm	480 cm
	U Table	21		
S22	Classroom	13	540 cm	420 cm
	U Table	12		
S31	Boardroom	8	490 cm	300 cm
S32	Classroom	13	490 cm	480 cm
	U Table	12		
S33	Classroom	13	490 cm	420 cm
	U Table	13		
S34	Classroom	13	490 cm	480 cm
	U Table	12		
S35	Boardroom	8	490 cm	360 cm
AU1	Auditorium (Chairs are fixed)	106	820 cm	1420 cm
AU2	Auditorium (Chairs are fixed)	104	820 cm	1420 cm

Combinations				
B31+B32	Classroom	27	540 cm	930 cm
	U Table	19		
B41+B42	Classroom	25	490 cm	790 cm
	U Table	19		
S11 + S12	Classroom	31	550 cm	930 cm
	U Table	21		
S21 + S22	Classroom	31	540 cm	910 cm
	U Table	21		
S31 + S32	Classroom	27	770 cm	780 cm
	U Table	19		
S31 + S32 + S33	Classroom	39	1185 cm	490 cm
	U Table	27		
S34 + S35	Classroom	27	830 cm	900 cm
	U Table	19	490 cm	480 cm

Deck 9 Conference Deck

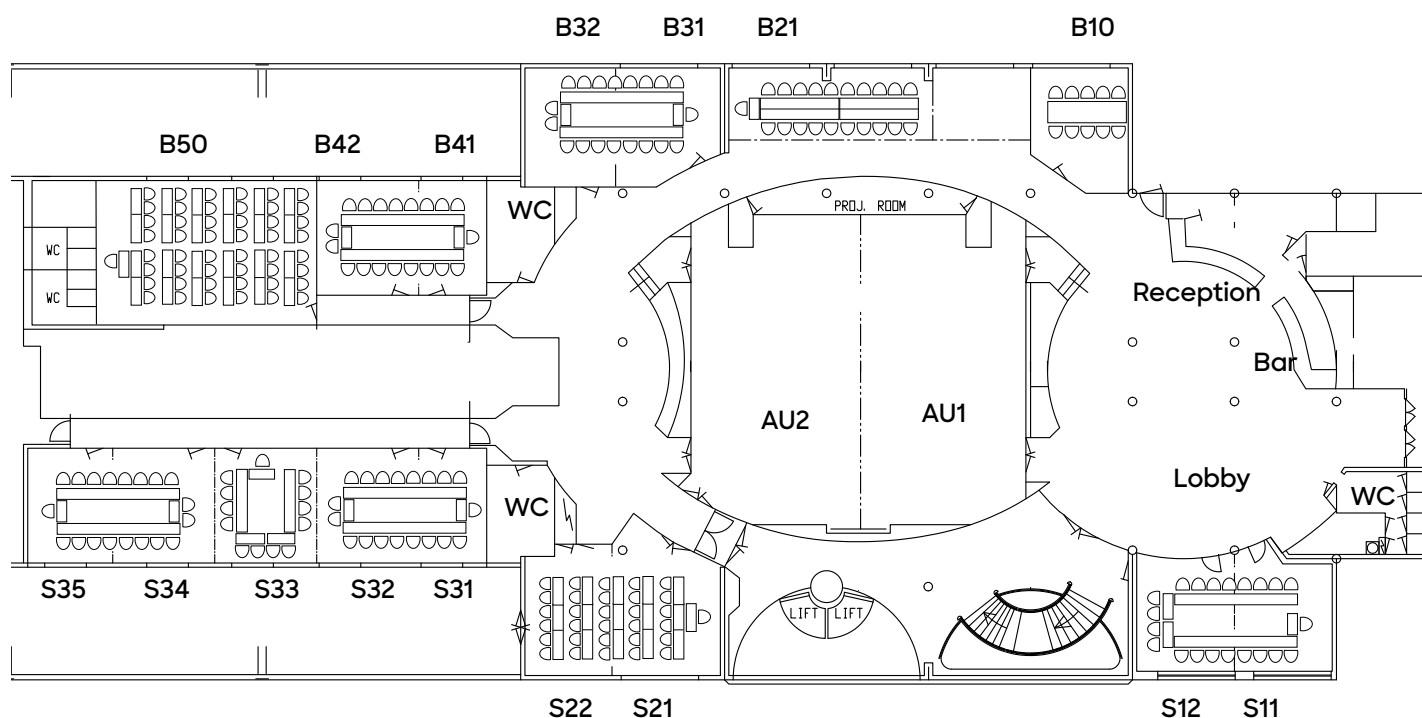

Deck 3 Cinderella Event Deck

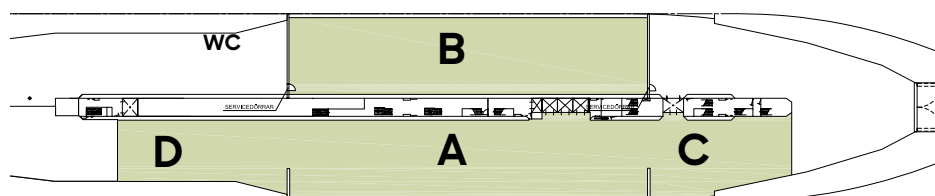

Area	Area m ²	Booking information
A	660 m ²	Always first
B	660 m ²	Only in combination with A
C	240 m ²	Only in combination with A
D	350 m ²	Only in combination with A
Total	1910 m ²	

Cinderella Event deck

Groups and Charter customers are invited to hire parts of the car deck as, for example, a large activity area. The event deck can be used only when the ship is in dock. Included in the rental price for such a booking is:

- textile coverings for the floor
- drapes for the walls
- ceiling lights
- electricity drawn to two central mains
- Viking Public Internet connections

Additional interior decoration and/or equipment can be ordered, with all costs paid by the customer

The following rules and regulations issued by the Swedish Maritime Administration must be followed when renting any of these four sections, for group and charter customers.

- No vehicles or other methods of transportation containing fuel, propellants, flammable liquids, or dangerous substances may be present on the car deck during the time it is being used for the event.

- The water tight passenger doors (on either side of A and B area) may not be opened during the event. These doors may only be opened when the Cinderella is berthed at her dock or otherwise lies at anchor.

Bookings via Viking Line 3 months in advance. The Event deck must be booked also for the cruise previous and after the event, because of work needed to transform the space for conference needs. Read more at vikingline.se.