

VIKING LINE

Conference on board



All Viking Line vessels have well equipped conference facilities for small and large groups. We offer a wide range of conference package options suitable for all needs. For further information kindly contact our Customer Service & Sales. The professional sales agents at our conference sales department will summarize your request and offer you the most suitable route and vessel. They will help you book your journey and answer all of your questions. Our professional conference center with its qualified staff on board will make sure your meeting is a success. We have the experience and the know-how to meet your needs.

Welcome on board!

Viking Grace

Däck 9 Conference deck

Standard equipment

- WLAN
- Loudspeakers
- LCD screen
- Flip chart
- Microphones (optional)
- Pens and note pads

Standard equipment in the auditorium

- Wireless microphones
- Projector and screen
- PC projector

Additional information:

- Possibility to present same audio/video material in several meeting rooms simultaneously
- Adjustable digital sign boards by the meeting rooms
- Total capacity of the conference area: 411 persons
- Speakers in all rooms and the lobby
- Standing desks can be rented for a fee if needed

Elevator capacity to the conference deck:

Door width 120 cm
Weight capacity 2,000 kg.

Code		Furnishing	Seating capacity	Room size	Room length, front to back
S21	Rumba	U Table	14	26 m ²	5.2 x 4.7 m
		Classroom	14		
S22	Boogie	U Table	14	25 m ²	5.2 x 4.7 m
		Classroom	14		
		Boardroom	12		
S23	Jive	U Table	14	25 m ²	5.2 x 4.7 m
		Classroom	14		
		Boardroom	12		
S24	Jazz	U Table	14	25 m ²	5.2 x 4.7 m
		Classroom	14		
		Boardroom	12		
S25	Mambo	U Table	14	25 m ²	5.2 x 4.8 m
		Classroom	14		
		Boardroom	12		
S26	Walz	U Table	14	25 m ²	5.2 x 4.7 m
		Classroom	14		
		Boardroom	12		
S27	Pasodoble	U Table	14	25 m ²	5.2 x 4.7 m
		Classroom	14		
		Boardroom	12		
S28	Foxtrot	U Table	14	25 m ²	5.2 x 4.7 m
		Classroom	14		
S31	Cha cha	Boardroom	10	23 m ²	4.8 x 4.5 m
SAB	Tango	Theatre seating	116		8.2 x 18.2 m
SAS2	Flamenco	Theatre seating	116		7.5 x 16.3 m

Combinations

S21+S22		30
S27+S28		30
SAB +SAS2	Main auditorium	230
S21 + S22 + S23 + S24 + S25 + S26 + S27 + S28		37.6 x 4.7 m

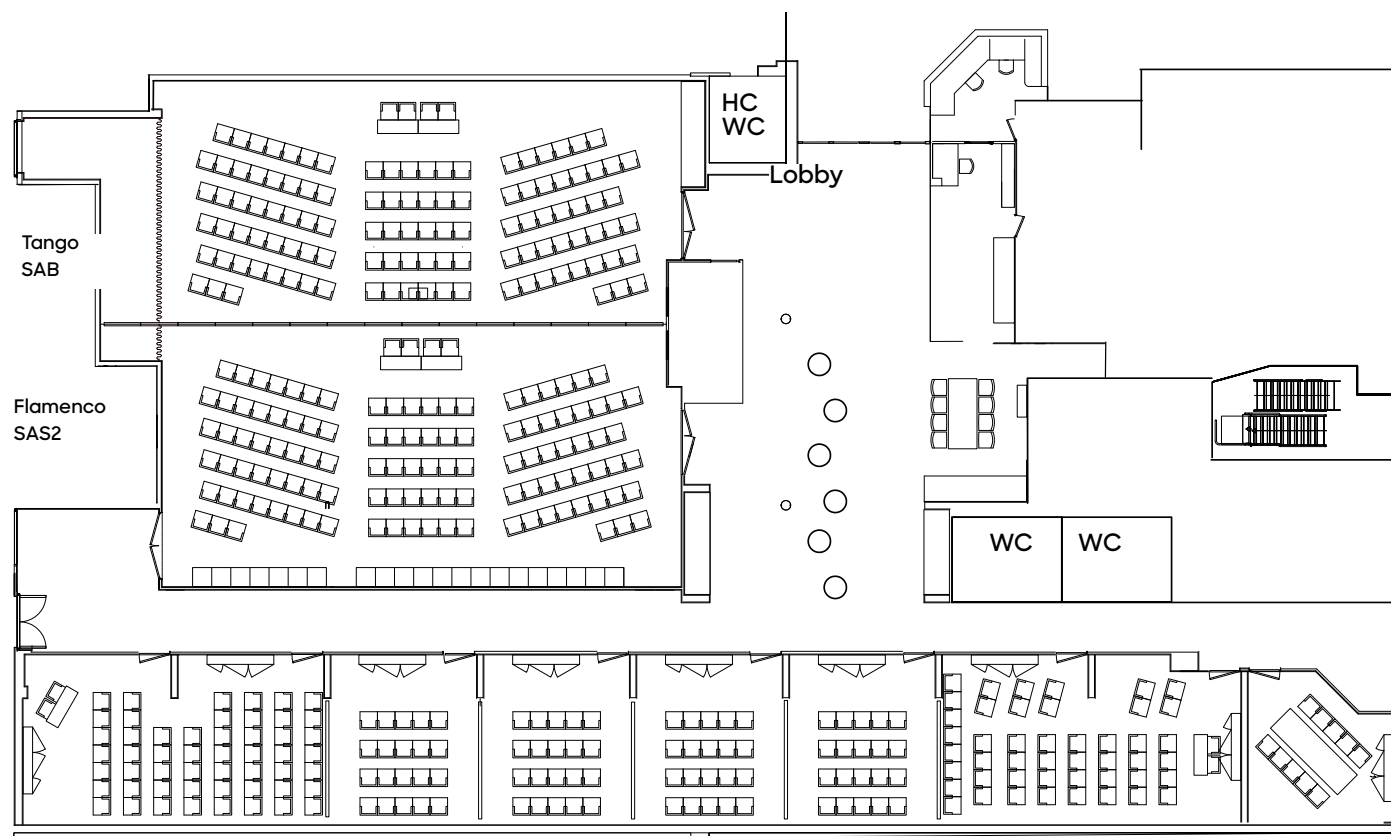

Rumba S21 Boogie S22 Jive S23 Jazz S24 Mambo S25 Waltz S26 Pasodoble S27 Foxtrot S28 Cha Cha S31